

Dual plate check valve, wafer type

Data sheet 2622 DP, Issue 1117 ME

☑ Dimensions in mm

Materials

Body	(1) GG25
Disc	(2) CF8
Seat	(3) EPDM
Spring	(4) Stainless steel
Hinge pin	(5) Stainless steel
Stop pin	(6) Stainless steel
Disc Bearings	(7) PTFE
Body bearings	(8) PTFE
Plug	(9) Steel
Pin stabilizer	(10) Rubber
Eye bolt	(11) Steel

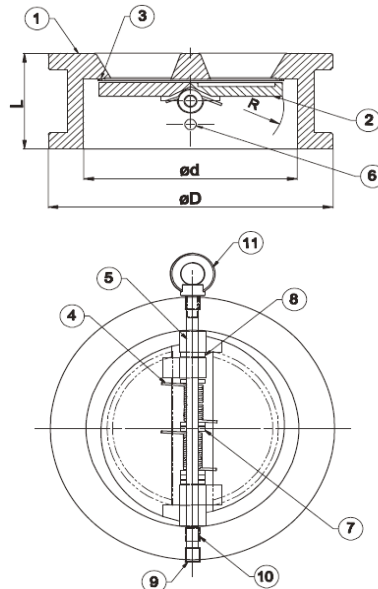

DN		Order Number	L	Ød	ØD	R
(mm)	(inch)					
65	2 1/2"	4 2622 31	46	73	127	36
80	3"	4 2622 32	64	89	142	45
100	4"	4 2622 33	64	114	160	56
125	5"	4 2622 34	70	141	192	70
150	6"	4 2622 35	76	168	213	83
200	8"	4 2622 36	89	219	270	105
250	10"	4 2622 37	114	273	334	135
300	12"	4 2622 38	114	324	380	156
350	14"	4 2622 39	127	360	446	176
400	16"	4 2622 40	140	410	498	200
450	18"	4 2622 41	152	450	550	221
500	20"	4 2622 42	152	500	610	252
600	24"	4 2622 43	178	624	720	306

☑ Specification

Temperature range	: -10°C ... +110°C
Pressure rate	: PN16
Flange Dimensions	: according to EN1092-2
Design standard	: EN 12334
Coating	: epoxy coated, blue RAL5000
For hot and cold water systems for fluids excluding acid and flammable fluids.	
The use of ethylene or propylene glycol in a mixing ratio 25- 50% is allowed.	

☑ Kvs Values

DN(mm)	65	80	100	125	150	200	250	300	350	400	450	500	600
Kvs(m³/h)	110	160	256	528	1087	1229	2372	3710	4583	5105	6021	9611	15752

All specifications and information within this document are reflecting the information available at the time of going to print and meant for informational purpose only. Herz Armaturen reserves the right to modify and change products as well as its technical specifications and/or its function according to technological progress and requirements. All diagrams are indicative in nature and do not to be complete. It is understood that all images of Herz products are symbolic representations and therefore may visually differ from the actual product. Colours may differ due to printing technology used. In case of any further questions don't hesitate to contact your closest HERZ Branch-Office.