

## Air Vent

Screwed Air Vent

Fig. 9701

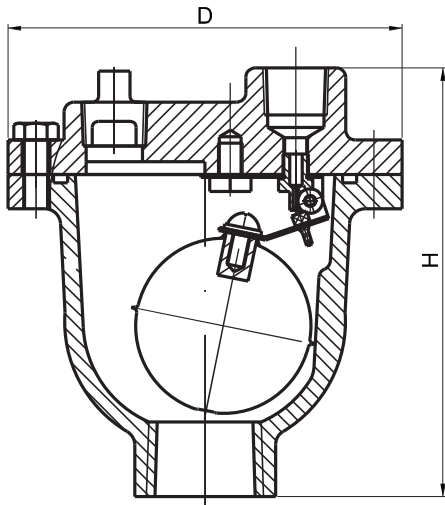

### Features

Screwed-in type, easy installation and maintainance

Heavy duty pattern with perfect function.

### Valve Standard

BS 21(IS07) / ASME B1.20.1

### Working pressure

16bar

### Working Temperature

-10°C to 100°C

### Flange Connection

CLASS 125 / PN16 / JIS 10K

### Coating

Fusion bonded epoxy coating  
Blue(RAL5015)/Black(RAL9005) or customized  
Thickness 300um above

### Materials List

Part Name	Material	Specification
Body	Cast Iron	A126 Class B
	Ductile Iron	A536 65-45-12
Cover	Cast Iron	A126 Class B
	Ductile Iron	A536 65-45-12
Seat Plug	Viton / EPDM	Commercial
Float	Stainless Steel	AISI 304
Float Arm	Stainless Steel	AISI 304
Orifice Button	Viton	Commercial

### Dimensions(mm/inch)

DN		Inlet	Outlet	Orifice	D	H
mm	inch					
15	1/2"	15	15	1.6	125	137
20	3/4"	20	15	1.6	125	137
25	1"	25	15	1.6	125	137
50	2"	50	15	1.6	125	137